

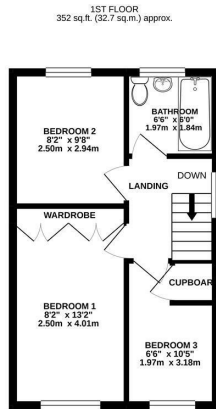

Keith
Ashton

Heather Close, Pilgrims Hatch
Brentwood

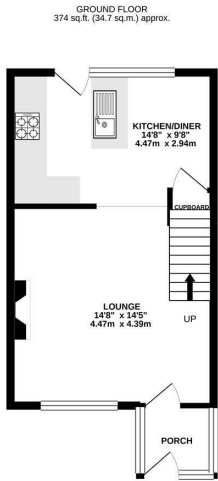

TOTAL FLOOR AREA: 726 sq.ft. (67.5 sq.m.) approx.
 While every effort has been made to ensure the accuracy of this information, the Agent does not warrant, represent or accept any liability for any errors, omissions or misstatements. This information is provided for general information only and should not be relied upon as a basis for any investment decision. The Agent is not responsible for any loss or damage caused by any reliance on this information. The Agent is not responsible for any loss or damage caused by any reliance on this information. The Agent is not responsible for any loss or damage caused by any reliance on this information. The Agent is not responsible for any loss or damage caused by any reliance on this information.



7 Heather Close, Pilgrims Hatch, Brentwood, CM15 9QX

We are pleased to offer this really well presented three bedroom end of terrace house situated in the popular Pilgrims Hatch area being both close to Brentwood town centre with its array of shops, restaurants and bars plus also open countryside and villages to the other side.

The property is entered via a useful porch to the open plan living space to the ground floor. The beautifully fitted kitchen features a walk-in pantry and central breakfast island as well as a dining area. The light and airy living room has a feature fireplace and large window to front.

To the first floor are two double bedrooms in addition to a further well proportioned single bedroom. A contemporary three piece white bathroom completes the internal layout.

Outside the pretty garden has a good-sized paved area perfect for al fresco dining which is bordered by delightful flower beds boasting a selection of mature plants and flowers. There is a gate to the rear providing access to parking space and a garage.

£390,000

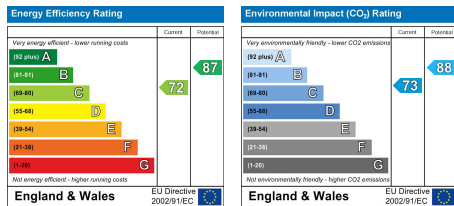

SERVICES:

Local Authority: Brentwood
 Council tax band: D
 Post code: CM15 9QX

VIEWING:

Strictly by prior arrangement with Keith Ashton Estate Agents

OPENING HOURS:

Monday to Friday: 8.45AM - 6.30PM | Saturdays: 9AM - 5.30PM | Sundays: 10AM - 2PM

MORTGAGE INFORMATION: We offer the additional facility of an in-house Independent Financial Adviser who will access all mortgage lenders with the purpose of providing you with the benefit of choice. For quotations or comparables please call 01277 260858 or visit our interactive website at www.mortgagebusiness.net



We the Agent have not tested any apparatus, fittings or services for this property. The plot size is intended merely as a guide and has not been officially measured or verified by the Agent. Photographs are for illustration only and may depict items which are not for sale or included in the sale of the property. As part of the service we offer we may recommend ancillary services to you which we believe may help you with your property transaction. We wish to make you aware, that should you decide to use these services we will receive a referral fee. For full and detailed information please visit 'terms and conditions' on our website www.keithashton.co.uk

Brentwood
Tel. 01277 260858

Village Office
Tel. 01277 375757

Lettings Office
Tel. 01277 202200

Explore more @ www.keithashton.co.uk

